

(3) 600 KCMIL - #2 AWG CONDUCTOR PORT

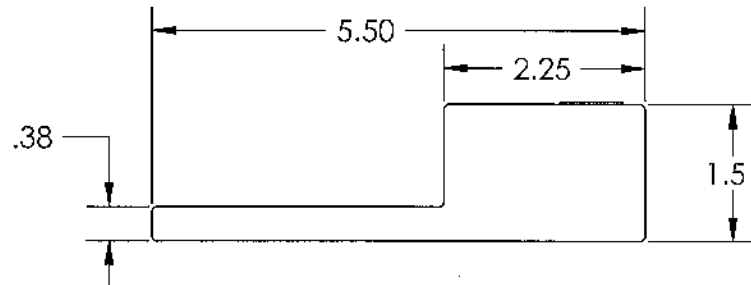

NOTES:
 1. TIN PLATED 6061-T6511 ALUMINUM ALLOY.
 2. UL LISTED 90° C FOR COPPER AND ALUMINIUM CONDUCTOR.

CONTACT NSI FOR SALES @ 800.321.5847



PROPRIETARY AND CONFIDENTIAL		TITLE: NSI 600 - 2 AL/CU HD Mech Lug 3-Port	
THE INFORMATION CONTAINED IN THIS DRAWING IS THE SOLE PROPERTY OF NSI Industries INC. ANY REPRODUCTION IN PART OR AS A WHOLE WITHOUT THE WRITTEN PERMISSION OF POLARIS SALES CO. INC. IS PROHIBITED.		DWG. NO. 3-600LL4	
NAME	DATE		
DRAWN BY KM	7/20/2012		
MATERIAL: 6061-T6511 ALUMINUM		SCALE: 1:1	SHEET: 1 OF 1